

Dynasty® 280 Series

TIG/Stick Welding Power Source  

Quick Specs



Industrial Applications

Precision fabrication
Heavy fabrication
Pipe and tube fabrication
Aerospace
Aluminum ship repair
Anodized aluminum fabrication

Processes

AC/DC TIG (GTAW)
Pulsed TIG (GTAW-P)
Stick (SMAW)
Air carbon arc (CAC-A)

Input Power 208–575 V, 3-phase or 1-phase power

Amperage Range 1–280 A (DC)
2–280 A (AC)

Rated Output 250 A at 20 V, 60% duty cycle

Net Weight 52 lb. (23.6 kg)



Dynasty 280

Dynasty 280 DX



Update and expand. Front panel memory card data port provides the ability to easily update software and expand product features.

Visit MillerWelds.com/TIGSoftware for the latest software updates and expansions.

Pro-Set™ eliminates the guesswork when setting weld parameters. Use Pro-Set when you want the speed, convenience and confidence of preset controls. Simply select the feature and adjust until Pro-Set appears on the display.

Sleep timer conserves electricity. This programmable feature will power down the machine if it sits idle for a specified time.



Allows for any input voltage hookup (208–575 V) with no manual linking, providing convenience in any job setting. Ideal solution for dirty or unreliable power.

Cooler Power Supply (CPS) is an integrated 120-volt dedicated-use receptacle for the Coolmate™ 1.3. Available on select models, see page 6.

Cooler-On-Demand™ feature operates the auxiliary cooling system only when needed, reducing noise, energy use, and airborne contaminants pulled through the cooler. Available on CPS models only.

Blue Lightning™ high-frequency (HF) arc starter for non-contact arc initiation. Provides more consistent arc starts and greater reliability compared to traditional HF arc starters.

Meter calibration allows digital meters to be calibrated for certification.

Wind Tunnel Technology™ protects internal electrical components from airborne contaminants, extending the product life.

Fan-On-Demand™ power source cooling system operates only when needed, reducing noise, energy use and the amount of contaminants pulled through the machine.



Power source is warranted for three years, parts and labor.



Miller Electric Mfg. LLC
An ITW Welding Company
1635 West Spencer Street
P.O. Box 1079
Appleton, WI 54912-1079 USA

Equipment Sales US and Canada
Phone: 866-931-9730
FAX: 800-637-2315
International Phone: 920-735-4554
International FAX: 920-735-4125

MillerWelds.com
    







Weld Process Features

AC TIG

Balance control provides adjustable oxide removal which is essential for creating the highest quality aluminum welds. DX models provide extended ranges.

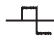
Frequency controls the width of the arc cone and can improve directional control of the arc.

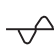
AC Waveforms

-  **Advanced squarewave**, fast freezing puddle, deep penetration and fast travel speeds.
-  **Soft squarewave** for a soft buttery arc with maximum puddle control and good wetting action.
-  **Sine wave** for customers that like a traditional arc. Quiet with good wetting.
-  **Triangular wave** reduces the heat input and is good on thin aluminum. Fast travel speeds.

DC TIG

Exceptionally smooth and precise arc for welding exotic materials.

AC/DC Stick

DIG control allows the arc characteristics to be changed for specific applications and electrodes. Lower the DIG setting for smooth running electrodes like E7018 and increase the DIG setting for stiffer, more penetrating electrodes like E6010.

Hot Start™ adaptive control provides positive arc starts without sticking.

AC frequency control adds stability for smoother welds when AC stick welding.

Stick-Stuck detects if the electrode is stuck to the part and turns the welding output off to safely and easily remove the electrode. Menu selectable.

Specifications (Subject to change without notice.)



| Welding Mode | Input Power | Welding Amperage Range | Rated Output at 60% Duty Cycle | Amps Input at Rated Load Output, 50/60 Hz | | | | | | Max. Open-Circuit Voltage | Dimensions | Net Weight | |
|--------------|-------------|------------------------------|--------------------------------|---|-------|-------|-------|-------|-----|---------------------------|----------------------|---|--|
| | | | | 208 V | 230 V | 400 V | 460 V | 575 V | KVA | KW | | | |
| TIG (GTAW) | 3-phase | 2–280 A (AC) 1–280 A (DC) | 250 A at 20 V | 21 | 19 | 11 | 9 | 7 | 7.6 | 7.3 | 60 VDC (11 VDC**) | H: 13.6 in. (346 mm) W: 8.6 in. (219 mm) D: 22.5 in. (569 mm) | 52 lb. (23.6 kg) 55 lb. (25 kg) with CPS |
| | 1-phase | 2–280 A (AC) 1–280 A (DC) | 250 A at 20 V | 35 | 32 | 18 | 16 | 13 | 7.3 | 7.1 | | | |
| Stick (SMAW) | 3-phase | 5–280 A | 250 A at 30 V | * | * | 14 | 13 | 10 | 9.9 | 9.6 | | | |
| | 1-phase | 5–280 A | 180 A at 27.2 V | 32 | 29 | * | * | * | 6.7 | 6.5 | | | |

* Refer to owner's manual for complete ratings. ** Sense voltage for low OCV stick and Lift-Arc™ TIG.

IP23 rating — This equipment is designed for outdoor use. It may be stored, but is not intended to be used outside during precipitation unless sheltered.

Operating temperature range is 14 to 104°F (-10 to 40°C). Storage temperature range is -22 to 149°F (-30 to 65°C). Portions of the preceding text are contained in EN 60974-1: "Welding power sources for arc welding equipment."

 Certified by Canadian Standards Association to both the Canadian and U.S. Standards.  All CE models conform to the applicable parts of the IEC 60974 series of standards.

Performance Data

| Input Power | TIG (GTAW) Duty Cycle | Stick (SMAW) Duty Cycle | AC TIG Material Thickness Range | DC TIG Material Thickness Range | Stick Electrode Maximum Diameter | Carbon Arc Gouging (CAC-A) Maximum | Generator Requirement |
|-------------|---|---|---------------------------------|---------------------------------|--|------------------------------------|-----------------------|
| 380–575 V | 280 A, 40% 250 A, 60% 200 A, 100% | 280 A, 35% 200 A, 60% 160 A, 100% | 0.012–3/8 in. (0.3–9.5 mm) | 0.004–3/8 in. (0.1–9.5 mm) | 6010: 1/4 in. (6.4 mm) 7018: 7/32 in. (5.6 mm) 7024: 3/16 in. (4.8 mm) | 3/16 in. (4.8 mm) | 12.5 kW |
| 208–240 V | 280 A, 40% 250 A, 60% 200 A, 100% | 280 A, 15% 180 A, 60% 160 A, 100% | | | | | |

Coolmate™ 1.3 Cooler



- Dynasty® models with CPS turn Coolmate 1.3 on and off
- Power indicator light
- Fluid level sight window
- Rustproof polyethylene-molded coolant tank and filler spout
- 1/4 hp motor is thermally protected to guard against overheating
- Efficient fin and tube heat exchanger
- Factory-set pressure relief valve (55 psi) maintains consistent pressure during operation
- Filter and coolant filling spout are conveniently located
- Brass-body, positive displacement rotary vane pump provides consistent coolant flow and pressure rating with long pump-life expectancy

| Input Power | Maximum Current Draw | Maximum Cooling Capacity | Rated Cooling Capacity | Tank Capacity | Dimensions | Net Weight |
|--------------|----------------------|---|--|------------------|---|-------------------|
| 115 V, 60 Hz | 4.7 A (60 Hz) | 3,400 W (11,600 Btu/hr.) 3.8 qt./min. (3.6 L/min.) | 1,330 W (4,540 Btu/hr.) 1.1 qt./min. (1 L/min.) | 1.3 gal. (4.9 L) | H: 11.25 in. (286 mm) W: 10.375 in. (264 mm) D: 24 in. (610 mm) | 43 lb. (20 kg) |

Weldcraft™ W-280 (WP-280) TIG Torch



- Two-piece torch head and exclusive Super Cool™ Technology provides additional surface area to increase cooling efficiency and capacity
- Torch body includes an anti-rotation feature and multi-position locking to prevent handle movement during welding and improve operator control
- Secure mechanical fittings and connections minimize leakage

| Cooling Method | AC Rating | DC Rating | Consumables | Electrode Range | Cable |
|----------------|------------------------|------------------------|-------------|---------------------------|-------------|
| Water-cooled | 195 A, 100% duty cycle | 280 A, 100% duty cycle | 13N | .020–1/8 in. (0.5–3.2 mm) | Three-piece |

Dynasty® 280 Control Panel

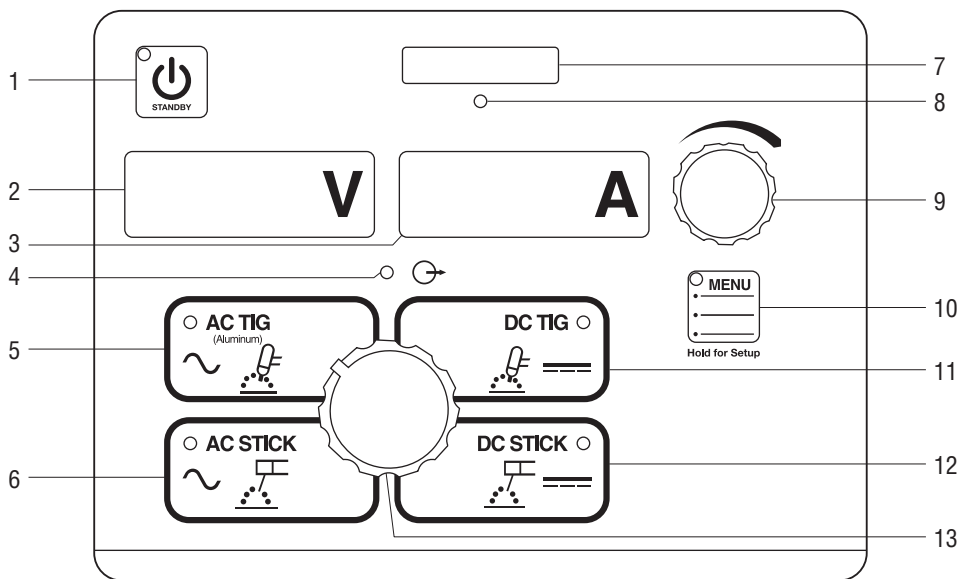

1. Standby Switch

2. Voltmeter Display

3. Ammeter Display

4. Output Contactor "On" Indicator

5. AC TIG Process Menu Parameters

| | |
|------------|---------------------|
| Amperage | 2–280 A** |
| Balance* | 60–80% |
| Frequency* | 70–150 Hz |
| Postflow | Auto/Off–50 seconds |

6. AC Stick Process Menu Parameters

| | |
|----------|----------|
| Amperage | 5–280 A |
| DIG* | Off–100% |

7. Memory Card Port

8. Activity Indicator

9. Encoder Control

10. Menu Ranges

11. DC TIG Process Menu Parameters

| | |
|----------|---------------------|
| Amperage | 1–280 A** |
| Pulse* | Off–250 pps |
| Postflow | Auto/Off–50 seconds |

12. DC Stick Process Menu Parameters

| | |
|----------|----------|
| Amperage | 5–280 A |
| DIG* | Off–100% |

13. Process Selector

*Pro-Set parameter selectable. **Amperage range is tungsten size dependent.

User Menu (Hold Menu button three seconds.)

AC TIG

1. Start = HF/Lift Arc
2. Tungsten Size = .020–1/8 in. or .05–3.2 mm
3. Remote Trigger = STD/HOLD/OUTPUT ON

AC Stick

1. Hot Start = ON/OFF
2. Remote Trigger = OUTPUT ON/STD

DC TIG

1. Start = Lift Arc/HF
2. Tungsten Size = .020–1/8 in. or .05–3.2 mm
3. Remote Trigger = STD/HOLD/OUTPUT ON

DC Stick

1. Hot Start = ON/OFF
2. Remote Trigger = OUTPUT ON/STD

Tech Menu (Hold Menu button five seconds.)

1. Arc Time
 - 0.0–9,999 hours
 - 0.0–59 minutes
 - 0–999,999 cycles
 - Resettable
2. Error Log = Error event recorder
3. Sleep Timer = 1/5/10/15/30/45MIN/1HR
4. Stick Stuc = OFF/ON
5. OCV = LOW/NORM
6. Cooler Power = AUTO/OFF (only on Dynasty models with CPS)
7. Machine Reset
8. Software Number
9. Serial Number

Dynasty® 280 DX Control Panel

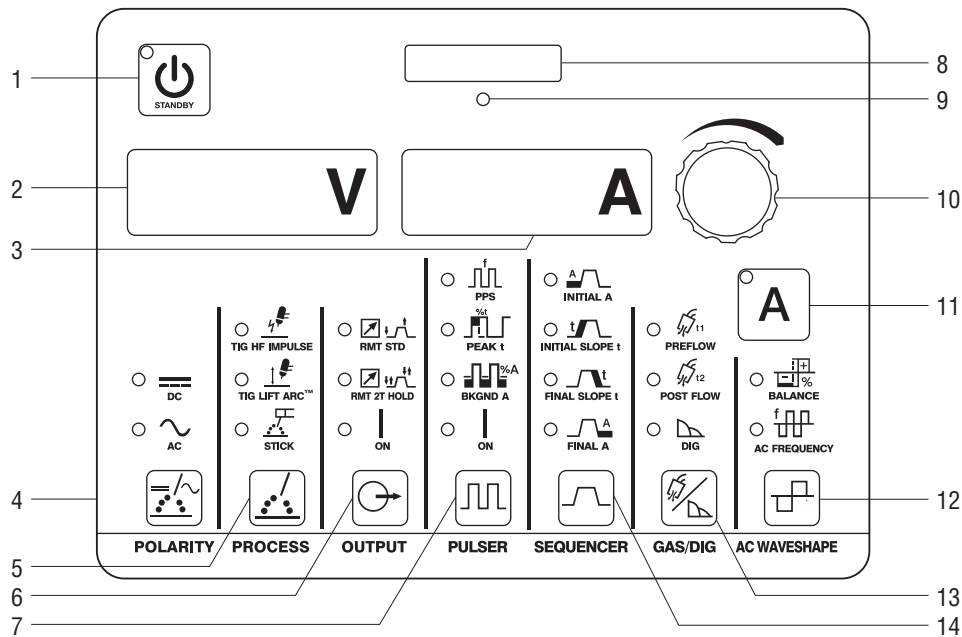

- | | |
|---|---|
| <p>1. Standby Switch</p> <p>2. Voltmeter Display</p> <p>3. Ammeter Display</p> <p>4. Polarity AC/DC</p> <p>5. Process/ Arc Starting TIG: HF impulse, Lift-Arc Stick: Adaptive Hot Start</p> <p>6. Output Control Standard remote, 2T trigger hold, Output on</p> <p>7. Pulser Control Pulses per Second* DC: 0.1–500 pps AC: 0.1–500 pps Peak Time* 5–95% Background Amps* 5–95%</p> <p>8. Memory Card Port</p> <p>9. Activity Indicator</p> <p>10. Encoder Control</p> | <p>11. Amperage Button</p> <p>12. AC Waveshape Balance* 50–99% EN Frequency* 20–400 Hz</p> <p>13. Gas/DIG Prewflow 0.0–25.0 seconds Postflow Auto/Off–50 seconds DIG* Off–100%</p> <p>14. Sequencer Control Initial Amps AC: 2–280 A DC: 1–280 A Initial Time 0.0–25.0 seconds Initial Slope 0.0–50.0 seconds Weld Time 0.0–999 seconds Final Slope 0.0–50.0 seconds Final Amps AC: 2–280 A DC: 1–280 A Final Time 0.0–25.0 seconds</p> |
|---|---|

*Pro-Set parameter selectable.

User Menu (Press Gas and Amperage buttons.)

1. Tungsten Size = .020–1/8 in./GEN or .05–3.2 mm
2. Remote Trigger = 3T/4T/4TL/4TLE
3. Wave Form = SOFT/ADVS/SINE/TRI
4. Stick Hot Start = ON/OFF

Tech Menu (Hold Gas and Amperage buttons five seconds.)

1. Arc Time 0.0–9,999 hours
0.0–59 minutes
0–999,999 cycles
Resettable
2. Error Log = Error event recorder
3. Sleep Timer = 1/5/10/15/30/45MIN/1HR
4. Stick Stuc = OFF/ON
5. OCV = LOW/NORM
6. Weld Timers = OFF/ON
7. Cooler Power = AUTO/ON/OFF (only on Dynasty models with CPS)
8. Locks = OFF/1–4
9. Meter Display
10. External Pulse Control = OFF/ON
11. Machine Reset
12. Software Number
13. Serial Number

Dynasty® 280 Models/Packages

Build an Air-Cooled Package

Select desired stock number for each step.



907550
Dynasty shown.



301311
kit shown.

| Step 1 • Select Dynasty | | Step 2 • Select Contractor Kit | |
|---|--------|--|--------|
| Dynasty 280 | 907550 | A-150 TIG Torch and RFCS-14 HD Foot Control | 301309 |
| Dynasty 280 (CPS) | 907537 | A-150 TIG Torch with RCCS-14 Fingertip Control | 301311 |
| Dynasty 280 DX | 907551 | A-200 TIG Torch with RFCS-14 HD Foot Control | 301549 |
| Dynasty 280 DX (CPS) | 907514 | A-200 TIG Torch with RCCS-14 Fingertip Control | 301550 |
| <p><i>Note: For models without the Cooler Power Supply (CPS), the Coolmate 1.3 must be powered through an external 120-volt facility power.</i></p> | | | |
| <p>Dynasty comes with adjustable shoulder strap, 8 ft. power cord (no plug), quick-reference guide and two 50 mm Dinse-style connectors.</p> | | <p>See page 7 for kit contents.</p> | |

Build a Water-Cooled Package

Select desired stock number for each step.



907537002
Dynasty 280
TIGRunner® shown
with four bottles
of 043810
Low-Conductivity
Coolant.



301580 remote shown.



300990 kit shown.

| Step 1 • Select Dynasty TIGRunner® and Coolant | Step 2 • Select Remote Control | Step 3 • Select Torch Kit | | | |
|---|-------------------------------------|------------------------------|-----------|-----------------------------|--------|
| Dynasty 280 (CPS) TIGRunner | 907537002 | Wireless Foot (recommended) | 301580 | W-250 Kit | 300185 |
| Dynasty 280 DX (CPS) TIGRunner | 907514001 | RFCS-14 HD Foot | 194744 | W-280 Kit | 300990 |
| & | | RCC-14 E/W Fingertip | 151086 | (recommended for 280 model) | |
| Low-Conductivity Coolant | 043810 | RCCS-14 N/S Fingertip | 043688 | W-375 Kit | 301268 |
| (Must be ordered in quantities of four.) | | RMS-14 Pushbutton | 187208 | | |
| | | RMLS-14 Momentary/Maintained | 129337 | | |
| | | RHC-14 Hand | 242211020 | | |
| | | Wireless Hand | 301582 | | |
| Dynasty TIGRunner comes with 8 ft. power cord (no plug), quick-reference guide, Coolmate™ 1.3 and Small Runner™ cart. | See page 7 for remote descriptions. | See page 7 for kit contents. | | | |

Water-Cooled Packages

Use a single stock number to order a complete preconfigured system.



951877
package shown.

| Select Water-Cooled Complete Package | |
|--|--------|
| Dynasty 280 (CPS) Complete with Foot Control | 951466 |
| Dynasty 280 DX (CPS) Complete with Foot Control | 951468 |
| Dynasty 280 DX (CPS) Complete with Wireless Foot Control | 951877 |
| Comes with: | |
| • 8 ft. power cord (no plug) | |
| • Quick-reference guide | |
| • Coolmate™ 1.3 300972 | |
| • Coolant (4 one-gallon bottles of 043810) | |
| • Small Runner™ cart 301318 | |
| • Remote control 194744 (foot) OR remote control 301580 (wireless foot) | |
| • W-280 torch kit 300990 (see page 7 for contents) | |

Genuine Miller® Accessories

Protective Cover 301382

Fits Dynasty 210/280 and Maxstar 280.



Small Runner™ Cart 301318

Designed for Dynasty/Maxstar 210 and 280 with or without Coolmate 1.3 cooler. Cart features single-cylinder rack, foot pedal holder, two cable/torch holders, and two TIG filler rod holders.



Coolmate™ 1.3 300972

120 V 1.3-gallon cooler designed to cool torches up to 280 amps.



Performance TIG Gloves

263346 Small
263347 Medium
263348 Large
263349 X-Large
Completely unlined, goat grain leather with triple-padded palm.

Memory Cards

Memory Card Expansion

301151 14-Pin Automation Expansion
Provides the ability to access common automation functions through the 14-pin connection.

301152 14-Pin Modbus® Expansion
Provides the ability to access basic and advanced functions through the 14-pin connection.

301235 Independent AC Expansion
Allows EP and EN amperages and waveforms to be set independently to precisely control heat input to the work and electrode.

Memory Card (Blank) 301080

A blank, commercially available memory card used for transferring software updates and expandable features from your computer to the machine.

TIG Torches, Kits and Connectors



Contractor kit 301311 shown.

Contractor Kits

301309 A-150 with RFCS-14 HD

301311 A-150 with RCCS-14

301549 A-200 with RFCS-14 HD

301550 A-200 with RCCS-14

All-in-one TIG/stick welding kit comes with either a Weldcraft™ A-150 **OR** A-200 TIG torch, RFCS-14 HD foot control **OR** RCCS-14 fingertip control, 200-amp stick electrode holder and 300-amp work clamp with 15-foot (4.6 m) cables, flow gauge regulator with 12-foot (3.7 m) gas hose, gas hose coupler, AK2C torch accessory kit and TIG torch connector.



Weldcraft™ A-200 (WP-26) TIG Torch
WP-26-12-R (12 ft.)
WP-26-25-R (25 ft.)
200-amp air-cooled torch. Torch body gas valve models also available.

Note: A-200 (WP-26) torches require **195379** connector.



Weldcraft™ A-250 TIG Torch
301525025 No valve
301526025 With valve
250-amp air-cooled two-piece torch with 25-foot (7.6 m) cable.

Note: Two-piece torches require connector:
042533 Dinse-style
191981 Tweco-style



Air-Cooled TIG Torch Connectors

195379 A-200 (WP-26)
195378* All others

50 mm Dinse-style for one-piece air-cooled torch.

*A-80 (WP-24) torches require **24-5** connector.



Water-Cooled Torch Kits

300185 W-250

300990 W-280 (recommended)

301268 W-375

Kit comes with Weldcraft™ 25-foot (7.6 m) TIG torch with Dinse-style connector, torch cable cover, work clamp with 15-foot (4.6 m) cable, flowmeter regulator with gas hose and AK4GL gas lens torch accessory kit.

Torch kit 300990 shown.



Water-Cooled TIG Torch Connector 195377

50 mm Dinse-style with water return line. For use with all Weldcraft™ water-cooled torches.

Remote Controls and Switches



Wireless Remote Foot Control 301580

For remote current and contactor control. Receiver plugs directly into the 14-pin receptacle of Miller machine. 90-foot (27.4 m) operating range.



RFCS-14 HD Foot Control 194744

Maximum flexibility is accomplished with a reconfigurable cord that can exit the front, back or either side of the pedal. Foot pedal provides remote current and contactor control. Includes 20-foot (6 m) cord and 14-pin plug.



RCC-14 Remote Contactor and Current Control 151086

East/west rotary-motion fingertip control attaches to TIG torch using two hook-and-loop fasteners. Includes 26.5-foot (8 m) control cord and 14-pin plug.



RCCS-14 Remote Contactor and Current Control 043688

North/south rotary-motion fingertip control attaches to TIG torch using two hook-and-loop fasteners. Includes 26.5-foot (8 m) cord and 14-pin plug.



RMS-14 On/Off Control 187208

Momentary-contact switch for contactor control. Rubber-covered pushbutton dome switch ideal for repetitive on-off applications. Includes 26.5-foot (8 m) cord and 14-pin plug.



RMLS-14 Switch 129337

Momentary- and maintained-contact rocker switch for contactor control. Push forward for maintained contact and backward for momentary contact. Includes 26.5-foot (8 m) cord and 14-pin plug.



RHC-14 Hand Control 242211020

Miniature hand control for remote current and contactor control. Dimensions: 4 x 4 x 3.25 inches (102 x 102 x 83 mm). Includes 20-foot (6 m) cord and 14-pin plug.



Wireless Remote Hand Control 301582

For remote current and contactor control. Receiver plugs directly into the 14-pin receptacle of Miller machine. 300-foot (91.4 m) operating range.

Educational Materials

To order, please call Miller Literature at 866-931-9732 or visit MillerWelds.com/resources/tools.

Gas Tungsten Arc Welding (TIG) Publication 250833

Setup DVD 251116

Video topics include tungsten selection, setup menus, DC pulse, sequencer, balance and frequency settings.

Tungsten

| Tungsten | Amp Range | 2% Ceriated (AC/DC) | 2% Lanthanated (AC/DC) |
|-------------------|-----------|---------------------|------------------------|
| 1/16 in. (1.6 mm) | 70–150 A | WC116X7 | WL2116X7 |
| 3/32 in. (2.4 mm) | 140–250 A | WC332X7 | WL2332X7 |
| 1/8 in. (3.2 mm) | 225–400 A | WC018X7 | WL2018X7 |
| 5/32 in. (4.0 mm) | 300–500 A | WC532X7 | WL2532X7 |

Ordering Information

| Equipment and Options | Stock No. | Description | Qty. | Price |
|---|--|--|------|-------|
| Dynasty® 280 | 907550 | Auto-Line™ 208–575 V, 50/60 Hz, CSA . 8 ft. power cord | | |
| Dynasty® 280 (CPS) | 907537 | Auto-Line™ 208–575 V, 50/60 Hz, CSA . 8 ft. power cord | | |
| Dynasty® 280 DX | 907551 | Auto-Line™ 208–575 V, 50/60 Hz, CSA . 8 ft. power cord | | |
| Dynasty® 280 DX (CPS) | 907514 | Auto-Line™ 208–575 V, 50/60 Hz, CSA . 8 ft. power cord | | |
| Dynasty® 280 DX (CPS) International | 907514002 | Auto-Line™ 208–575 V, 50/60 Hz, CE . 8 ft. power cord | | |
| Water-Cooled Packages | | | | |
| Dynasty® 280 (CPS) TIGRunner® | 907537002 | Auto-Line™ 208–575 V, 50/60 Hz, CSA . 8 ft. power cord (Torch kit, accessories and coolant sold separately) | | |
| Dynasty® 280 DX (CPS) TIGRunner® | 907514001 | Auto-Line™ 208–575 V, 50/60 Hz, CSA . 8 ft. power cord (Torch kit, accessories and coolant sold separately) | | |
| Dynasty® 280 (CPS) Complete w/Foot Control | 951466 | Auto-Line™ 208–575 V, 50/60 Hz, CSA . 8 ft. power cord | | |
| Dynasty® 280 DX (CPS) Complete w/Foot Control | 951468 | Auto-Line™ 208–575 V, 50/60 Hz, CSA . 8 ft. power cord | | |
| Dynasty® 280 DX (CPS) Complete w/Wireless Foot Control | 951877 | Auto-Line™ 208–575 V, 50/60 Hz, CSA . 8 ft. power cord | | |
| Accessories | | | | |
| Protective Cover | 301382 | For Dynasty 210/280 and Maxstar 280 | | |
| Small Runner™ Cart | 301318 | For Dynasty/Maxstar 210 and 280 with or without Coolmate 1.3 | | |
| Coolmate™ 1.3 | 300972 | 120 V, 60 Hz, CSA . <i>Requires coolant</i> | | |
| TIG Coolant (must be ordered in quantities of four) | 043810 | 1-gallon plastic bottle. Protects against freezing to -37° Fahrenheit (-38°C) or boiling to 227° Fahrenheit (108°C) | | |
| TIG Gloves | | See page 7 | | |
| Memory Cards | | See page 7 | | |
| TIG Torches, Kits and Connectors | | | | |
| Air-Cooled Contractor Kits | | See page 7 | | |
| Weldcraft™ A-150 (WP-17) TIG Torch | WP-17-12-R WP-17-25-R | 12 ft. (3.7 m) cable. Requires 195378 connector 25 ft. (7.6 m) cable. Requires 195378 connector | | |
| Weldcraft™ A-200 (WP-26) TIG Torch | WP-26-12-R WP-26-25-R | 12 ft. (3.7 m) cable. Requires 195379 connector 25 ft. (7.6 m) cable. Requires 195379 connector | | |
| Weldcraft™ A-250 TIG Torch | 301525025 301525026 | No valve. 25 ft. (7.6 m) cable With valve. 25 ft. (7.6 m) cable | | |
| Air-Cooled TIG Torch Connectors | 195379 195378 | Connects Weldcraft™ A-200 (WP-26) torch to Dinse-style connector Connects all air-cooled Weldcraft™ torches (except A-200) to Dinse-style connector. A-80 (WP-24) torches require 24-5 connector | | |
| Water-Cooled Torch Kits | | See page 7 | | |
| Water-Cooled TIG Torch Connector | 195377 | Connects Weldcraft™ water-cooled torches to Dinse-style connector | | |
| Tungsten | | See above | | |
| Remote Controls | | See page 7 | | |
| Educational Materials | | See page 7 | | |

Date:

Total Quoted Price:

Distributed by:

